

Safety signs fall into five categories:

### Prohibitive Signs

These signs are of a round shape, represented by a black pictogram on a white background, a red edge with diagonal line and are used to prevent an action where there is danger. Examples of prohibitive signs are:



### Warning Signs

These signs are triangular and have a black pictogram on a yellow background with black edging. They warn of a danger and for precautions and / or care to be taken to prevent harm. Examples of warning signs are:



### Mandatory Signs

Mandatory signs require that specified actions are to be followed. These signs are typically associated with the compulsory wearing of personal protective equipment. They are round in shape have a white pictogram on a blue background. Examples of mandatory signs include:

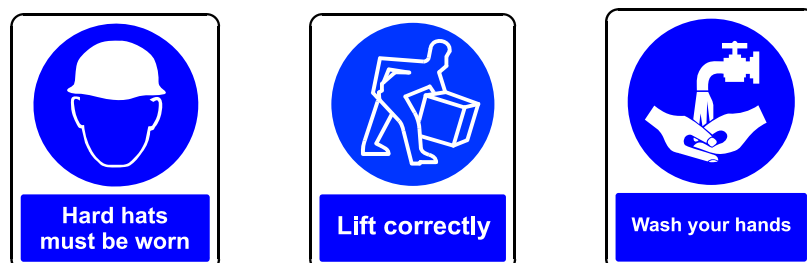

### Emergency or First Aid Signs

Signage		Date printed:	19/05/2009
Owned by Graham Fieldhouse	Approved by	Issue level and date:	Version 001 -08/05/09
		Revision date	08/05/10
UNCONTROLLED WHEN PRINTED OR DOWNLOADED		Page	Page 1 of 5

These signs are rectangular or square in shape and have a white pictogram on a green background and provide instructions on the safe way of doing something or where a safety item is located. The most common use of these signs is to provide directions as to the nearest fire escape route. Examples of these signs are:

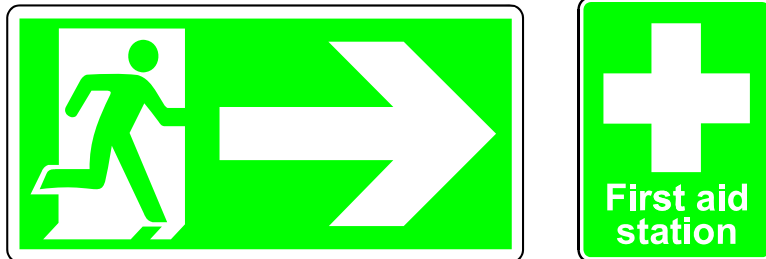

### Fire Fighting Signs

These signs are rectangular or square in shape and have a white pictogram on a red background and are used to identify and locate fire fighting equipment. Examples are:



Signage		Date printed:	19/05/2009
Owned by Graham Fieldhouse	Approved by	Issue level and date:	Version 001 –08/05/09
		Revision date	08/05/10
UNCONTROLLED WHEN PRINTED OR DOWNLOADED		Page	Page 2 of 5